

Installation instructions

- Audi A4 Saloon 2012 ▶**
 - Audi A4 Avant 2012 ▶**
 - Audi A5 Sportback 2013 ▶**
 - Audi A5 Coupé 2013 ▶**
 - Audi A5 Cabriolet 2013 ▶**
 - Audi Q5 2013 ▶**
- Audi drive select**
Audi Genuine Accessories

Edition 05/2015



Contents

1	General notes	1
2	Parts overview	2
3	Sequence of operations	3
3.1	Preparations	3
3.2	Installing Audi drive select	3
3.2.1	Routing the retrofit wire for the switch module for driving mode selection -E592-	4
3.3	Replacing the accelerator pedal module with accelerator position sender -G79-/ -G185- tauschen	5
3.4	Assembling the vehicle	5
3.5	Initialising and coding Audi drive select	6
3.5.1	Coding the interface control unit	6
3.6	Returning the vehicle	7



1 General notes

Please read and apply these WARNING, Caution and Note descriptions before carrying out maintenance or repair work.

 **WARNING**

Text with this symbol contains information concerning your safety and indicates potential accident and injury risks.

 **Caution**

Text with this symbol indicates the risk of damage to your vehicle.

 **Note**

Text with this symbol contains additional information.

 **Note**

The description of the installation work is accurate at the time of printing. New equipment versions ⇒ ELSA.

Special tools are required for assembly. Improper installation can cause damage to the vehicle.

Audi AG shall not accept responsibility in the event of failure to comply with these assembly instructions.



2 Parts overview

Parts required

Contents of Audi drive select installation package for vehicles with automatic gearboxes 8K0.063.765

Units	Part number	Designation
1	8K0.063.764	Wiring harness for Audi drive select
1	8K0.051.850.G	Activation document
1	WSK.014.720.HK	Installation instructions

Contents of Audi drive select installation package for left-hand and right-hand drive vehicles with manual gearboxes 8K0.063.765.A

Units	Part number	Designation
1	8K0.063.764	Wiring harness for Audi drive select
1	8K0.051.850.B	Activation document
1	WSK.014.720.HK	Installation instructions
1	8K1.723.523.A	Accelerator pedal module with accelerator position sender -G79- / -G185-

Switch module for driving mode selection to be replaced -E592-

Existing part number	To be replaced with
8K0.959.673.L	8K0.959.673.K
8K2.959.674.Q	8K2.959.674.P
8K2.959.674.N	8K2.959.674.M
8K2.959.674.L	8K2.959.674.K



3 Sequence of operations

3.1 Preparations

- Disconnect the battery -A- ⇒ Rep. gr. 27.
- Remove the control unit 1 for information electronics -J794- ⇒ Rep. gr. 91 .
- Remove the switch module for driving mode selection -E592- ⇒ Rep. gr. 96.
- Remove the control unit in the dash panel insert -J285- ⇒ Rep. gr. 90.
- Remove the onboard supply control unit -J519- ⇒ Rep. gr. 97.

Only on vehicles with manual gearboxes:

- Remove the accelerator pedal module with accelerator position sender -G79-/ -G185- ⇒ Rep. gr. 20.

3.2 Installing Audi drive select

- Disconnect the electrical connector -3- from the switch module for driving mode selection -E592- -2- in the direction of the arrow-.
- Insert the new switch module for driving mode selection -E592- into control unit 1 for information electronics -J794- and make sure that the switch module engages audibly.
- Pin the yellow/grey retrofit wire -1- into the electrical connector -3- for the switch module for driving mode selection -E592- -2- as follows:
 - ◆ Pin the yellow/grey retrofit wire -1- into “pin 7” and make sure that it engages audibly.

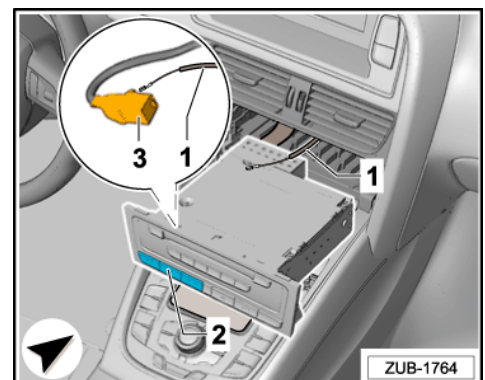
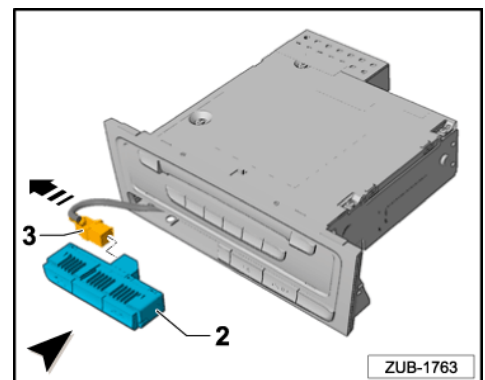



- Clip the electrical connector -3- complete with yellow/grey retrofit wire -1- onto the switch module for driving mode selection -E592- -2-.

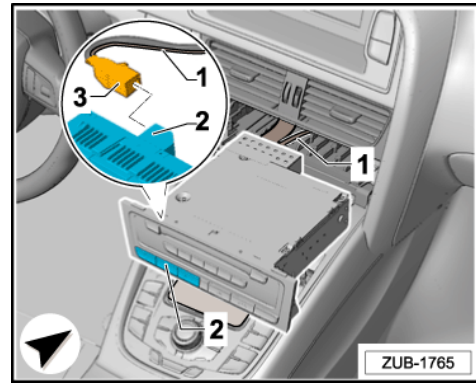

3.2.1 Routing the retrofit wire for the switch module for driving mode selection -E592-

- Feed the yellow/grey retrofit wire -1- behind the control unit in the dash panel insert -J285- and use cable ties -arrows- to secure the wire to the existing wiring harness.

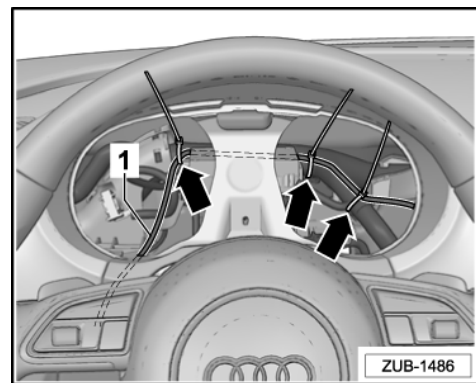

- Pull the yellow/grey retrofit wire downwards to the grey plug A -4-.
- Secure the yellow/grey retrofit wire to the existing wiring harness of the onboard supply control unit -J519-.

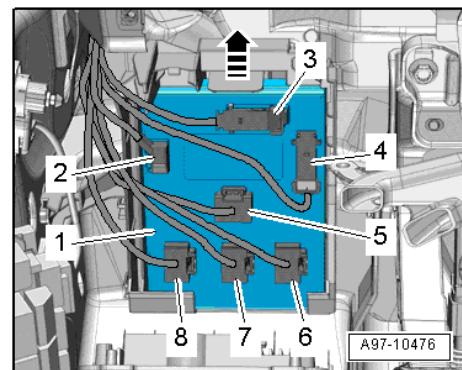



- Pin the yellow/grey retrofit wire to the front of the onboard supply control unit -J519- -A- as follows:
 - ◆ 32-pin grey A5 electrical connector, “pin 16 ”

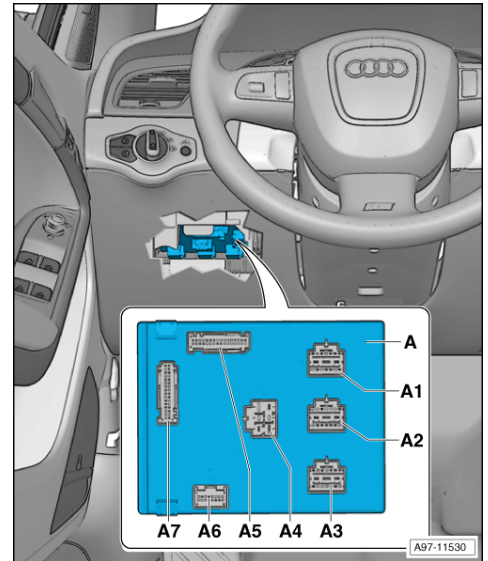

3.3 Replacing the accelerator pedal module with accelerator position sender -G79-/-G185- tauschen

Note

Only on vehicles with manual gearboxes:

- Remove the accelerator pedal module with accelerator position sender -G79-/-G185- ⇒ Rep. gr. 70.

Note

If necessary, replace existing pedal covers with pedal covers from the existing retrofit kit or style package.

3.4 Assembling the vehicle

- Secure any retrofitted wires to the original wiring harness using cable ties to prevent noises and abrasion.

Assembly is carried out in the reverse of the order already stated.

Notes on connecting the battery

- To connect, manually place the battery clamp of the earth wire on the battery negative terminal “-” and tighten the nut.

If the battery is being reconnected, the following steps must be taken:

- ◆ Activate the one-touch opening/closing of the electric windows ⇒ Operating Manual.
- ◆ Synchronise secondary and additional keys to make sure that the remote control function is working correctly. To do this, insert the key into the ignition lock, switch the ignition on and off again, and remove the key.



- ◆ Call up the fault memory of all control units and delete the "Undervoltage" ("Unterspannung") fault as necessary ⇒ Vehicle diagnostic tester.

i Note

After reconnecting the power supply, the ESP warning light can only extinguish after a few metres have been driven.

3.5 Initialising and coding Audi drive select

Special tools and workshop equipment required

- ◆ Diagnostic system -VAS 6160 A-
- ◆ Remote diagnosis head -VAS 5054A- or diagnostic interface -VAS 5055-

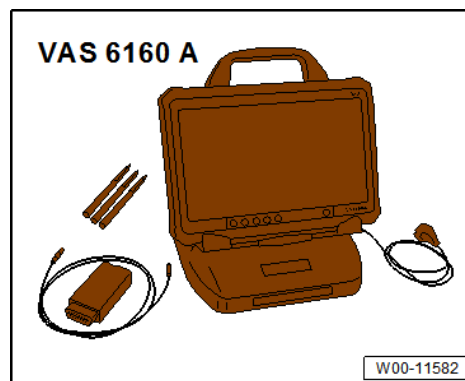

3.5.1 Coding the interface control unit

i Note

An activation document is used to perform an activation.

Sequence of operations:

- Insert the connector of the remote diagnosis head -VAS 5054A- into the diagnostic connection in the vehicle -image-.
- Switch on ignition.
- Select
- In the SVM (software version management), select the "Activation" ("Freischaltung") test program.
- While working through the menu, the data from the activation document will need to be entered (the process is outlined in the activation document).
- Call up the fault memory of all control units and delete the "Undervoltage" ("Unterspannung") fault as necessary ⇒ Vehicle diagnostic tester.
- If necessary, test the headlight basic setting.



i Note

Following the activation process, the vehicle must be put into "bus sleep mode", otherwise the full scope of the function that has just been activated cannot be used.



3.6 Returning the vehicle

The system functions must be explained to the customer when returning the vehicle.